



Life is a Festival. Celebrate it Everyday!

The logo for Sunny Crest is a decorative graphic. It features the word "Sunny" in a large, orange, serif font. A yellow sunflower with a dark brown center is positioned to the right of the "y" in "Sunny". A thin, dotted line with small orange flowers at the end curves around the "y" and extends upwards. Below "Sunny" is the word "Crest" in a smaller, black, serif font. The "C" in "Crest" has a decorative swirl on its left side, and the "y" in "Sunny" has a decorative swirl on its right side.

Sunny  
Crest



Elevation Of Excellence !

  
**Sunny**  
Crest





Elevation Of Excellence !

  
**Sunny**  
Crest



Imagine a life where the world revolves around you. Where the city and all that you need - surrounds you. Amidst a nature-soaked environ with 24/7 security for your family. Where safety, comfort to joy - all come together.

It's called Sunny Crest!



116 Cozy, Contemporary Apartments in Kalitala, Kolkata

**Sunny**  
Crest

# Sunny Crest



Night View



## The Environment is Distinctly Green and Natural



If nature means wellness, your home should be surrounded by it. A marked play - zone for the kids, the garden to rest you and the elderly. Jog in the mornings. Converse by the scenic beauty in the evenings. At SUNNY CREST, nature comes to you with a home attached.





## The Environment is Distinctly Green and Natural

Kid's  
Play Area

Landscape  
Garden

Beautified  
Pond

57% Open  
Space

If nature means wellness, your home should be surrounded by it.

A marked play - zone for the kids, the garden to rest you and the elderly. Jog in the mornings. Converse by the scenic beauty

in the evenings. At SUNNY CREST, nature comes to you

with a home attached.





Landscaped Garden View



Community Hall



## When You Want to Celebrate It Becomes an Occasion



Let the plush lobby welcome you. Start the morning in the pool. A work-out in the Gymnasium keeps you fit for the entire day. Unwind in the Club-House. A charming banquet celebrates your evening. Make indulgences your habit. What makes you happy is for you to decide.





Community Hall



## When You Want to Celebrate It Becomes an Occasion

Indoor Games

Swimming Pool/  
Jacuzzi

Gymnasium

Community Hall

Let the plush lobby welcome you. Start the morning in the pool. A work-out in the Gymnasium keeps you fit for the entire day. Unwind in the Club-House. A charming banquet celebrates your evening. Make indulgences your habit. What makes you happy is for you to decide.





Swimming Pool View

# Site Plan





# Floor Plans

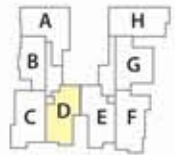

## BLOCK 1 | FLAT D

TYPICAL FLOOR  
 SBUA - 1316 SQFT  
 BHK - 3

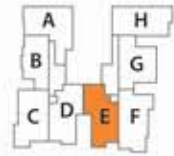

## BLOCK 1 | FLAT E

TYPICAL FLOOR  
 SBUA - 1330 SQFT  
 BHK - 3

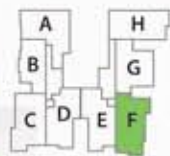

## BLOCK 1 | FLAT F

TYPICAL FLOOR  
 SBUA - 1397 SQFT  
 BHK - 3

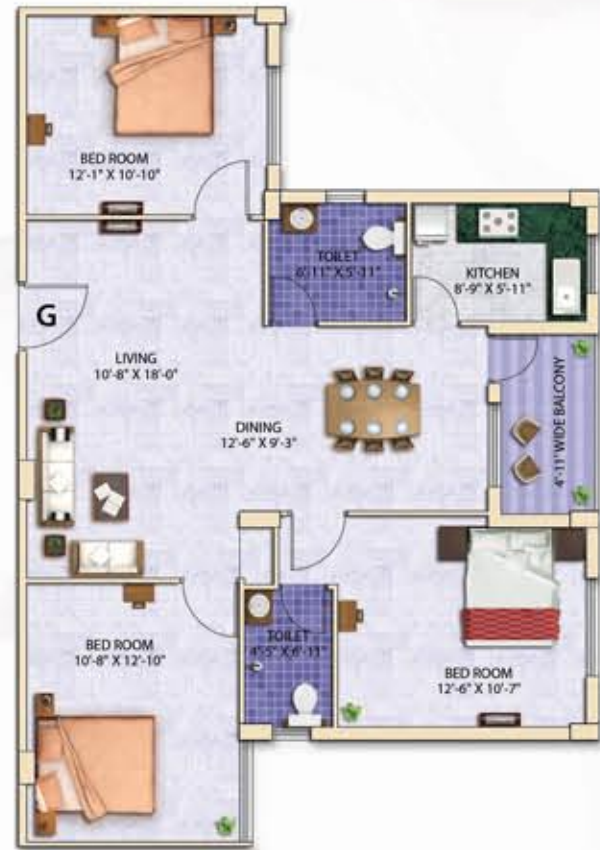

## BLOCK 1 | FLAT G

TYPICAL FLOOR  
 SBUA - 1307 SQFT  
 BHK - 3

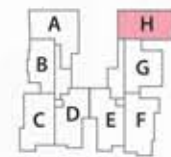

## BLOCK 1 | FLAT H

TYPICAL FLOOR  
 SBUA - 1341 SQFT  
 BHK - 3

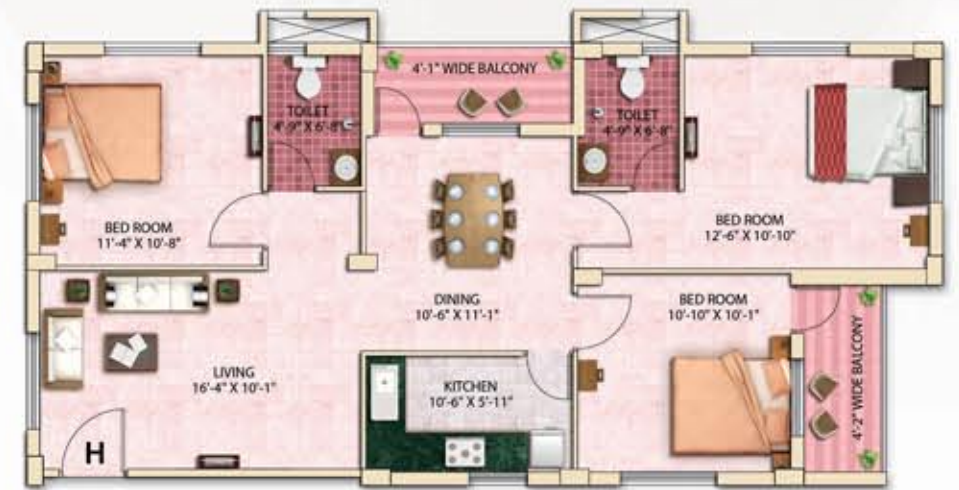

# Floor Plans



# Floor Plans



**BLOCK 2 | TYPICAL FLOOR**

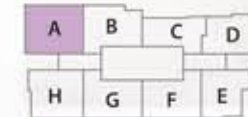

**BLOCK 2 | FLAT A**

TYPICAL FLOOR

SBUA - 1363 SQFT

BHK - 3

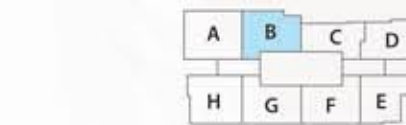

**BLOCK 2 | FLAT B**

TYPICAL FLOOR

SBUA - 1205 SQFT

BHK - 3

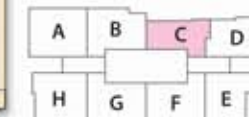

**BLOCK 2 | FLAT C**

TYPICAL FLOOR

SBUA - 926 SQFT

BHK - 2



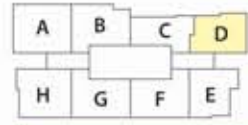

### BLOCK 2 | FLAT D

TYPICAL FLOOR  
 SBUA - 1014 SQFT  
 BHK - 2

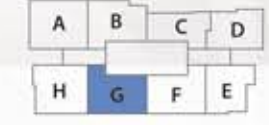

### BLOCK 2 | FLAT G

TYPICAL FLOOR  
 SBUA - 1192 SQFT  
 BHK - 3

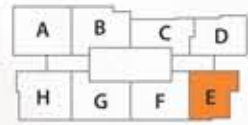

### BLOCK 2 | FLAT E

TYPICAL FLOOR  
 SBUA - 1030 SQFT  
 BHK - 2

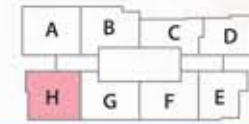

### BLOCK 2 | FLAT H

TYPICAL FLOOR  
 SBUA - 1255 SQFT  
 BHK - 3

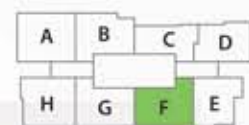

### BLOCK 2 | FLAT F

TYPICAL FLOOR  
 SBUA - 1176 SQFT  
 BHK - 3



# Floor Plans

# Floor Plans



**BLOCK 3 | TYPICAL FLOOR**



**BLOCK 3 | FLAT A**

TYPICAL FLOOR  
 SBUA - 1390 SQFT  
 BHK - 3

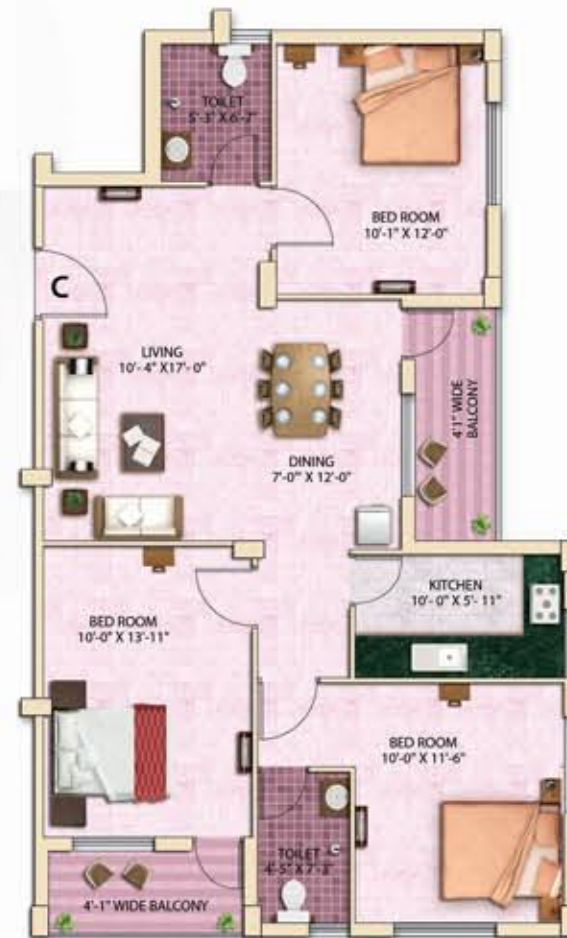
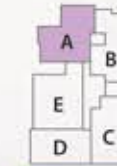

**BLOCK 3 | FLAT C**

TYPICAL FLOOR  
 SBUA - 1298 SQFT  
 BHK - 3

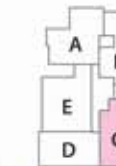

**BLOCK 3 | FLAT B**

TYPICAL FLOOR  
 SBUA - 1231 SQFT  
 BHK - 3



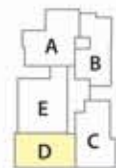

### BLOCK 3 | FLAT D

TYPICAL FLOOR  
 SBUA - 1152 SQFT  
 BHK - 3 | TERRACE - 118 SQFT

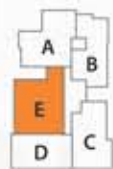

### BLOCK 3 | FLAT E

TYPICAL FLOOR  
 SBUA - 1308 SQFT  
 BHK - 3 | TERRACE - 118 SQFT



### BLOCK 4 | TYPICAL FLOOR



# Floor Plans

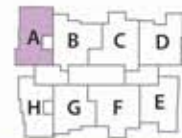

## BLOCK 4 | FLAT A

TYPICAL FLOOR  
 SBUA - 1373 SQFT  
 BHK - 3

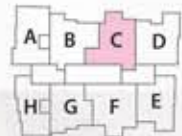
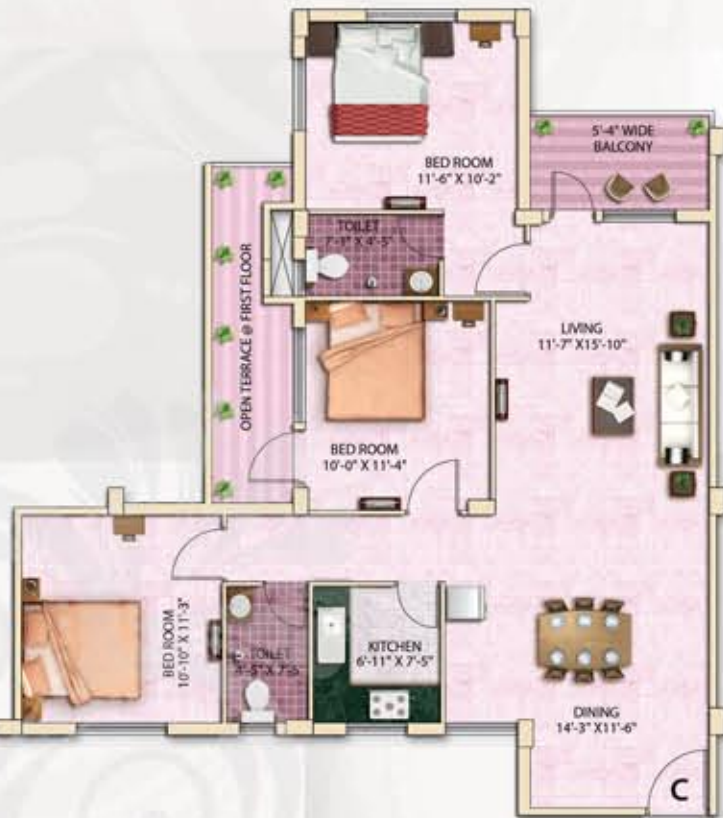

## BLOCK 4 | FLAT C

TYPICAL FLOOR  
 SBUA - 1394 SQFT  
 BHK - 3 | TERRACE - 84 SQFT

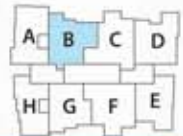

## BLOCK 4 | FLAT B

TYPICAL FLOOR  
 SBUA - 1415 SQFT  
 BHK - 3 | TERRACE - 84 SQFT

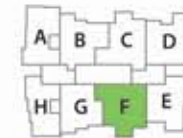

## BLOCK 4 | FLAT F

TYPICAL FLOOR  
 SBUA - 1348 SQFT  
 BHK - 3 | TERRACE - 169 SQFT



## BLOCK 4 | FLAT D

TYPICAL FLOOR  
 SBUA - 1440 SQFT  
 BHK - 3



## BLOCK 4 | FLAT E

TYPICAL FLOOR  
 SBUA - 1331 SQFT  
 BHK - 3



# Floor Plans



# Floor Plans



## BLOCK 4 | FLAT G

TYPICAL FLOOR  
 SBUA - 1323 SQFT  
 BHK - 3

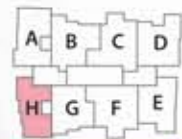

## BLOCK 4 | FLAT H

TYPICAL FLOOR  
 SBUA - 1240 SQFT  
 BHK - 3

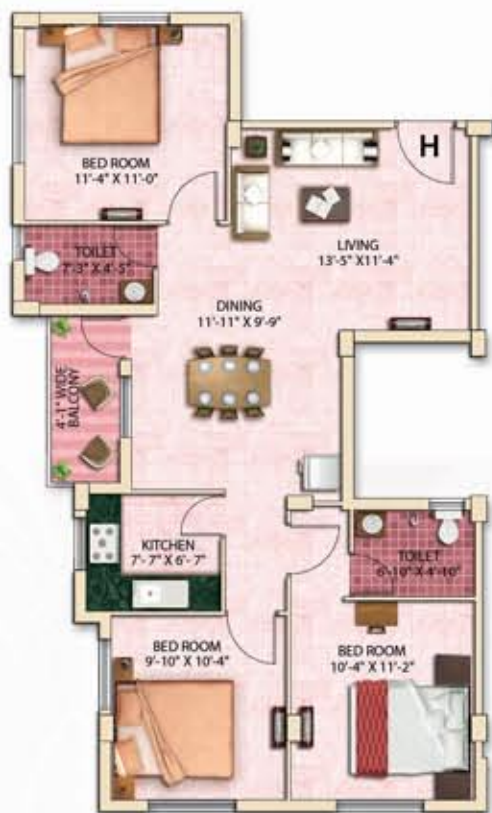

Out of The World Except in The Address.

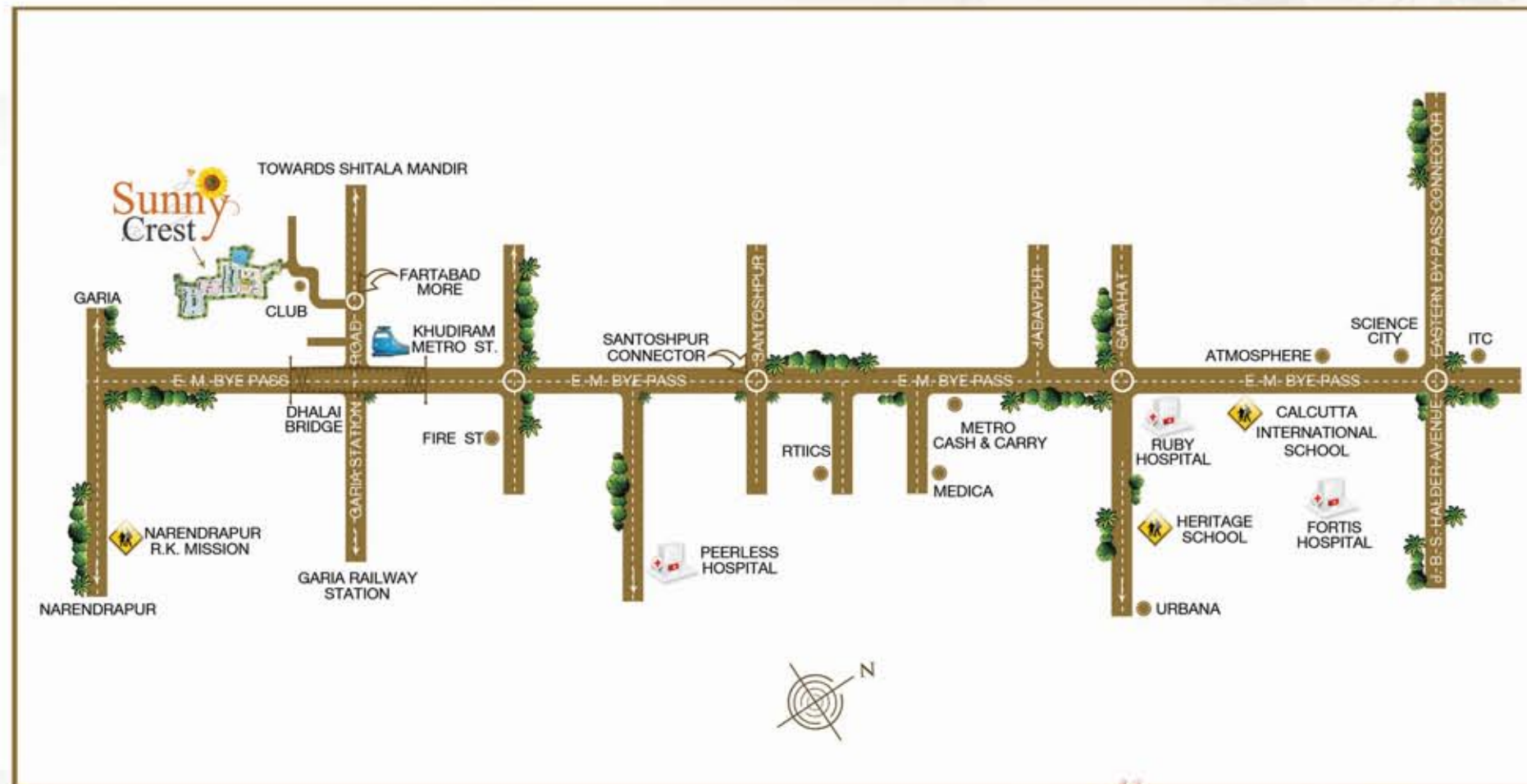

Located in Kalitala Area, it's amazing you can be so close to the Khudiram Metro Station and its landmarks. From Schools, Colleges, Hospitals, Offices, Malls - you are well connected. Via E.M. Bypass. It's a zone that finds a fine balance between energy and peace. Just your kind of avenue.

### Key Distances

Khudiram Metro Station 2 mins · Garia Railway Station 5 mins · Remedy Hospital 5 mins  
 B.D. Memorial & Welland Gouldsmith School 10 mins · Hiland Park-Big Bazaar 10 mins



Elevation of Excellence



# Specifications

## Structure

RCC-framed structure with anti-termite treatment in foundation.

## External Finish

Quality wooden frames with solid core flush doors. Main door with one side teak veneer.

## Windows

Colour anodized/powder coated aluminium sliding windows with glass.

## Flooring

Vitrified tiles in bedrooms/living/dining. Anti skid tiles in toilet & kitchen.

## Kitchen Counter

Granite slab with stainless steel sink. Wall tiles upto two feet height above counter.

## Toilets

Internal piping with CPVC pipes. CP fittings of Hindware/equivalent. Dado of ceramic tiles upto door height. Sanitaryware of Hindware/equivalent.

Provision for hot and cold water supply in all toilets.

## Elevator

Passenger lifts of reputed brand.

## Internal Finish

Wall putt.

## Electrical

(a) Concealed copper wiring with modular switches of Havells/equivalent.

(b) TV & Telephone points in master bedroom and living room.

(c) Two Light Points, one Fan Point, two 5A points in all bedrooms. 1 AC Points in all bedrooms.

(d) One 15A Geyser point in all toilets.

(e) Modern MCBs and changeovers of Havells/equivalent.

Water Supply : Underground and overhead storage

## Generator

24 hour power back-up for all common services. Generator back up of 500W for 2 bedroom flats and 750W for 3 bedroom flats.

# Founded on the Country's Finest Expertise in Construction

Todi Constructions, the Developer I can trust:

Sunny Crest is being constructed by Todi Constructions Pvt. Ltd. Under the directorship of Mr. Manoj and Manish Todi. Todi Constructions has created an unstinted reputation for itself.

Mr. Manoj Todi has been associated with construction of a number of landmark projects in the Southern part of Kolkata - Sunny Bloom, Sunny Dew, Sunny Valley, Sunny Season and Sunny Dale among them. Mr. Manish Todi has also developed impressive projects like Skyline Lakeview, Skyline Mansion and Skyline Residency. They bring with them decades old experience of constructing exclusive residential complexes. There is absolute certainty that Sunny Crest will also come out to be an excellent hallmark of a great housing community.

## Past Projects



SKYLINE LAKEVIEW



SUNNY DALE



SUNNY DEW



SUNNY SEASONS



SUNNY VALLEY



SUNNY BLISS

Elevation of Life



## SITE ADDRESS

2726, Kalitala, Garia, Kolkata - 700 084

## DEVELOPER



**Todi Constructions Pvt. Ltd.**

Plot- FB-13, 1598, Rajdanga Main Road, Kolkata - 700 107

Ph 033 4063 0402 / 9674346400

E-mail [todiconstructions@gmail.com](mailto:todiconstructions@gmail.com)

## ASSOCIATES



**STARLITE GROUP**

Plot- FB-13, 1598, Rajdanga Main Road, Kolkata - 700 107

Ph 033 4063 0403 / 9674722223

Web [www.starliteindia.com](http://www.starliteindia.com)



**GROUP**

2, Iswar Ganguly Street, 1st Floor

Kolkata - 700 026

Web [www.skylineprojects.in](http://www.skylineprojects.in)

## ARCHITECT



**Associates Consultant Pvt.Ltd.**

**SANYALSON ASSOCIATES CONSULTANT (P) LTD.**

### DISCLAIMER

All details in this booklet are for easy information and concept purposes only, and do not form part of the agreement. This document is tentative and developer reserve the right to make variations and modifications.